

Ready-to-use
for your weighing applications

BX65 *PLUS*

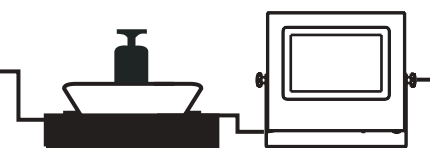

BX65Plus Label Weighing Application Terminal



BAYKON
Industrial Weighing Systems

Low cost with high benefit price ratio weighing terminal. Ready-to-use for your workspace.



- ✓ Selectable weighing applications; Weighing and Labelling, Serial and Additive Totalizing, Formulation, Checkweighing, & Catchweighing, Portioning,
- ✓ Run with your company logo at start-up.
- ✓ Sealed model as IP67 protected for wet and hygienic areas
- ✓ Powerful ERP integration options
- ✓ Configurable Weighing Menu, Labels and Report
- ✓ Easy, efficient operation with 7" color touch screen



Weighing & Labelling

- ✓ 12 User-definable data fields like Product, Batch No, etc.
- ✓ Data entry with touch screen, external PC keypad, and Barcode/RFID reader.
- ✓ For tabular questions, ability to enter data with images
- ✓ Thanks to definable conditions such as mandatory data entry, tabular entry, save old entry, etc. operator guidance for easy and error-free operation.
- ✓ Automatic tare with stability
- ✓ Automatic tare in connection with a product or a data entry like package type.
- ✓ Multi-Language menu: English, Turkish, German, French, Italian, Spanish



Smart Labelling

- ✓ Labels within any complexity, in desired size and the language.
- ✓ The company logo, all type of Barcode type like Code 128, EAN 13, QR code,
- ✓ Baykon Label Design PC software for easy and practical label design, uploading and downloading labels.
- ✓ 3 different weighing label options in memory that can be , printed via Serial and Ethernet port,
- ✓ Special tag code for automatic printing the expiry date as day, month, year.
- ✓ Ability to print statistical data such as Average Weight, Standard Deviation, Range, Minmum Weight, Maksimum Weight.

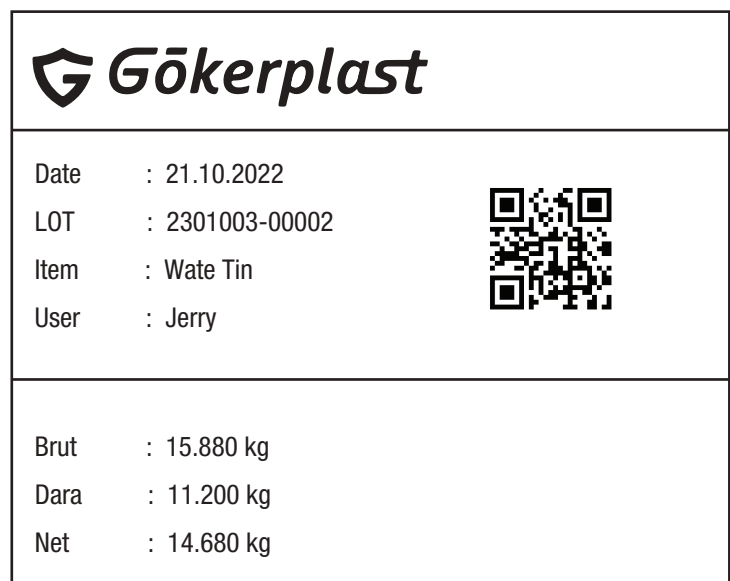
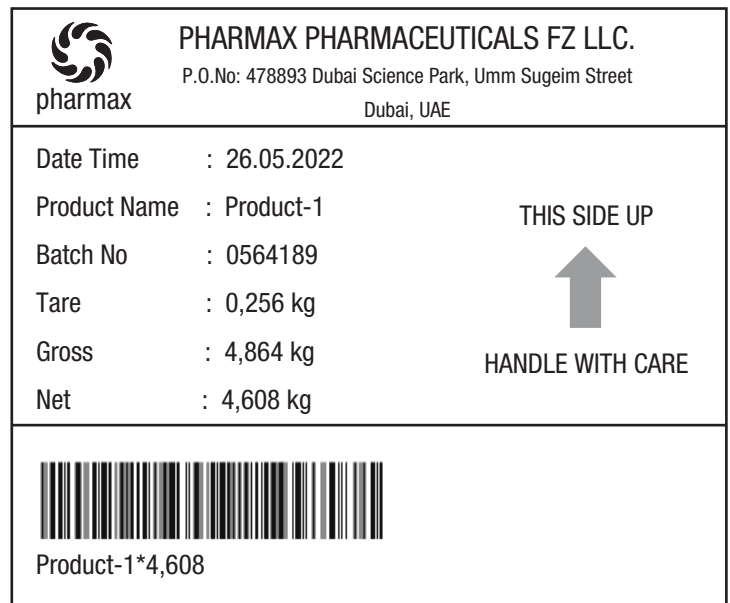

Totalising Modes

The totalizing modes are the sequential weighing of packages within a batch. The packages can be collected on a pallet or in a box.

- ✓ Last Box No, Current Pallet No and Total Weight are shown on the weighing screen.
- ✓ Apart from Weighing Label, Detailed or Summary Pallet ticket or Totalizing Ticket can be printed.
- ✓ Automatic pallet ticket by counting number of boxes on pallet.
- ✓ Statistical data can be printed on total ticket.

Serial Totalising

Products in a batch are weighed one by one, palletized or put in a box.



Additive Totalising

The products in a batch are weighed additively on the scale onto a pallet or in a box



Formulation Mode

With the formulation mode, the ingredients in a recipe are weighed in order and a recipe report is created

- ✓ Saving the weight of ingredients individually.
- ✓ Configurable recipe report.

Date & Time	: 04/03/2024 11:11:16		
Ticket No	: 265		
Product	: Product-A		
Customer	: Customer-B		

Item	Tare (kg)	Gross (kg)	Net (kg)
1	19.0	61.5	42.5
2	11.0	65.5	54.5
3	12.0	69.5	57.5
4	14.5	69.5	55.0

	56.5	266.0	209.5

Standard Deviation	: 6.7		
Min. Weight	: 42.5		
Max. Weight	: 57.5		
Average Weight	: 52.4		
Weight Range	: 15.0		

Date & Time	: 29/02/2024 14:26:09		
Ticket No	: 248		
Product	: Product-A		
Customer	: Customer-A		
Pallet No	: 2		
Number of item	: 5		
Total Gross	: 281.0		
Item	Gross(kg)		
6	36.5		
7	42.5		
8	68.0		
9	62.5		
10	71.5		

Date & Time	: 12/03/2024 10:35:45	
Ticket No	: 186	
Batch No	: B23461	
Operator	: Mark-002	

Ingredient-1	21,0 kg	
Ingredient-2	10.3 kg	
Ingredient-3	15,2 kg	
Ingredient-4	16,3 kg	

Total:	62,8 kg	



Checkweighing Mode

It is to check the weight or the quantity of prepackaged products. This Mode is also used as Catchweigher without tolerance control.

- ✓ GROSS or NET weight control.
- ✓ Automatic product selection with specific Target, +/- Tolerances.
- ✓ Automatic taring linked to product or any entry like package type.
- ✓ Displays Total weight, number of boxes and pallets on display
- ✓ Guidance with RED-GREEN-YELLOW colors for LIGHT-OK-HEAVY
- ✓ Indicating the difference with target weight
- ✓ Manuel or automatic label for parcels and pallets
- ✓ Option for saving records only in tolerances.
- ✓ Automatic zeroing input
- ✓ Relay outputs for Light, OK, Heavy and Error status.
- ✓ External precision balance connection for high precision products.

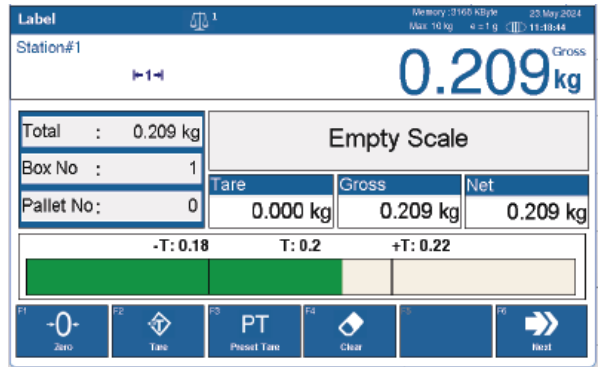

Checkweighing or Catchweighing with conveyor scale

1. Parcel is coming on the Inlet Conveyor

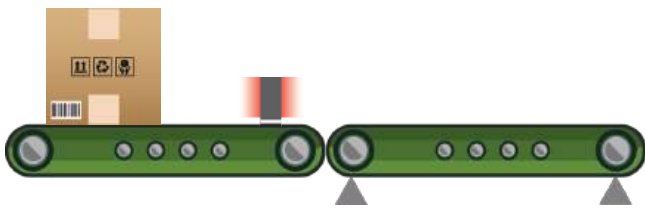

2. Scale is automatically zeroed with Zeroing Sensor Input.

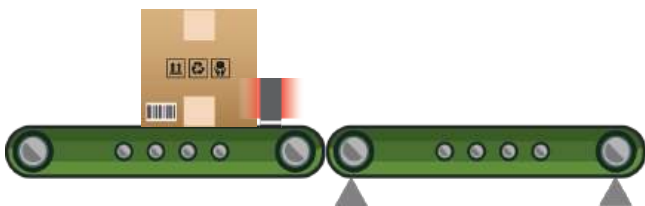

3. Stable weight is captured automatically.

“RED” or “GREEN” or “YELLOW” color for “LIGHT”, “OK” or “HEAVY”.

“Reject” output for out of tolerances.

“Run the conveyor” output if stopped.

“Error” output if stable weight is not captured

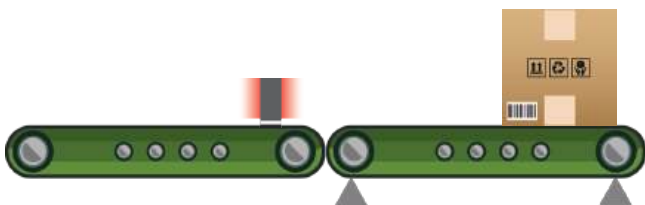

Portioning Mode

With the Portioning mode, the products can be portioned to a target value by weight or number within specified tolerances

- ✓ Guidance with color changing bar as RED-GREEN-YELLOW indicating LIGHT-OK-HEAVY.
- ✓ Total weight, number of boxes and pallets are shown on the monitor.
- ✓ Ease of operation with an extra operation display showing the difference weight or quantity to the target value.
- ✓ Operation display becomes GREEN in case of stability.
- ✓ Product specific Target, +/- Tolerances are taken from product table.
- ✓ External precision balance connection for high precision products



Individual

- ✓ Empty or partially filled containers are portioned on the scale.
- ✓ Automatic taring with stability for empty containers.
- ✓ For partially filled containers, automatic tare linked to product or any entry like package type.



Multiple

- ✓ Portioning multiple empty containers in a case on the scale.
- ✓ Net portioning with automatic tare with stability.

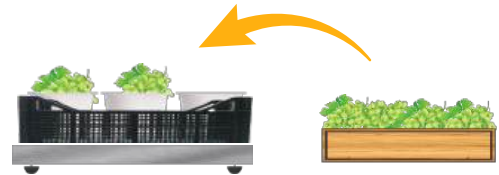

Take Away

- ✓ Portioning products from a full case on the scale into empty containers.
- ✓ Net portioning with automatic tare with stability.



Data Management & ERP Integration

Weighing records are always saved in the BX65PLUS memory can be transferred to the ERP system by the following methods:

1) Records can be transferred by USB Flash memory.

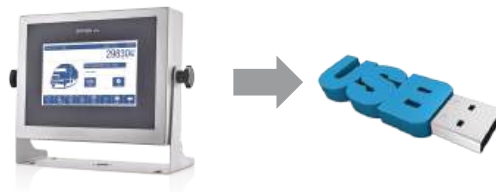

2) With Baykon Data Editor PC Software

- ✓ Records are transferred as Excel file.
- ✓ Tables of tabular fields including Product table can be downloaded from PC to BX65PLUS.



3) Direct transfer to SQL Server with WEB Service

- ✓ Records are transferred directly to SQL Server.
- ✓ Records are stored on the BX65PLUS when there is no connection to the SQL Server.
When the SQL Server connection is restored, the records are automatically transferred to the Server.



4) Weight indication as barcode on the monitor to integrate directly into your system with a barcode reader.

This function is activated by entering the 1D/2D parameter in Setup/System Setup/Display Setup

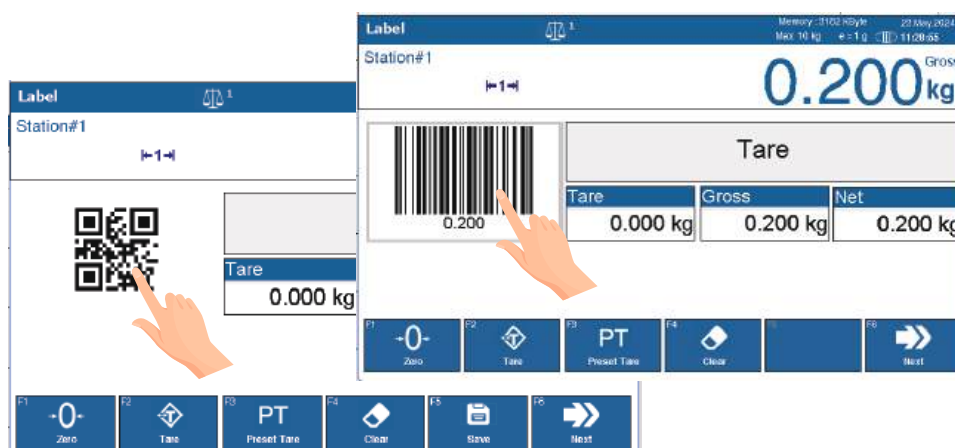

Technical Specifications

Model	BX65
Accuracy class & EU type approval	OIML class III, single range, multi range or multi interval up to 10.000 division
Display	Active TFT 7" color LCD Touchscreen
Display resolution	Up to 500 000
A/D conversion	24 bit Delta-Sigma ADC
Minimum input sensitivity	0.4 $\mu\text{V}/e$ (Legal for trade), 0.1 $\mu\text{V}/d$ (Industrial usage)
Analogue input range	-5 mV to +19 mV
Internal resolution	Up to 16 000 000 counts
Keyboard	Softkeys with Tare, Clear, Zero, Print and Functions
Status annunciators	Gross, net, motion, center of zero, units
Conversion rate	Up to 1600 conversions per second
Operation system	Windows CE
Calibration	Calibration with test weights, eCal- Electronic calibration without test weights, Zero adjustment, Gain adjustment, Coefficient entry
Digital filter	5 Adjustable adaptive digital filter
Scale functions	Taring, zeroing, auto zero tracking, motion detection, auto-zero at power-up, automatic taring, automatic clear, automatic print
Standard application software	Basic weighing (BX65 - Basic) Truck Scale (BX65 - Truck) Labelling & Data Collection (BX65 - Label) Milk Collection Scale (BX65 - Milk) Net weight control (BX65 - SCQ) Customized software solutions (BX65-Custom)
Languages	English, German, French, Spanish, Italian, Arabic, Russian, Hebrew, Turkish
Interface	2 x USB, RS232C, Centronis Parallel Port, Ethernet TCP/IP (10 / 100)
Digital I/O (Optional)	4 digital isolated inputs / 4 digital relay outputs
Load cell excitation	5 VDC, max. 125 mA
Number of load cells	Up to 8 load cells 350 Ω or up to 24 load cells 1150 Ω (min. 43 Ω)
Load cells connection	4 or 6 wire technique, cable length 1000 m/mm ² for 6 wire connection
Operation temperature	-15°C ~ +55°C max. (Operational), -10°C ~ +40°C (Legal metrology)
Humidity	Max. 90% non-condensing relative humidity legal metrology max. 80 %
Enclosure	Stainless steel, Desk & wall type, IP30 & IP67
Power requirement	90 - 240 V AC, 50 / 60 Hz or 11-28VDC

Connectable Peripherals



Barcode Reader



RFID Reader



Printer



Keyboard & Mouse



Remote Display



Tower Lamp



Precision Balance

Dimensions (mm)

