

BR200SD

Digital Compression Load Cell

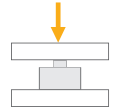

Applications



Truck Scales



Tank, Bunker,
Silo Weighing



High Capacity
Applications



Special
Weighing

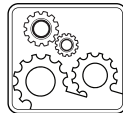

Industrial
Processes

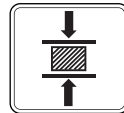

Testing
Machines

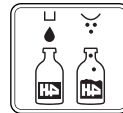

Packing & Filling
Applications

Key Features

- Digital data output
- 2.5 ~ 20 t Capacities
- Stainless steel
- Protection class: IP68

BR200SD is a compression-type digital load cell with a stainless-steel, low-profile structure suitable for accurate and reliable measurement in all kinds of industrial weighing applications thanks to its advanced electronic design and high resolution. With its washdown, corrosion-resistant stainless-steel, IP68 sealed protection class structure, BR200SD is perfect for use in different hygienic or harsh industrial environments, especially in food and chemistry.

It prevents incorrect weighing in case of any load cell failure in the weighing system and enables easy and fast diagnostic of the malfunction with the relevant error code guidance. BAYKON BR200SD digital load cells have normalized production features that eliminate the need for readjustment after replacing a defective load cell.

Technical Specifications

Model		BR200SD
Capacity (E_{max})	t	2.5 / 5 / 10 / 15 / 20
Accuracy class		G3
Internal resolution (Max.)	Count @ E_{max}	8 000 000
Temperature effect on zero	% $E_{max}/10^{\circ}C$	≤ 0.015
Temperature effect on sensitivity	% $E_{max}/10^{\circ}C$	≤ 0.01
Combined error	% E_{max}	$\leq \pm 0.05$
Zero balance	% E_{max}	$\leq \pm 0.1$
Creep error (30 minutes)	% E_{max}	$\leq \pm 0.03$
Safe load limit	% E_{max}	150
Ultimate load	% E_{max}	300
Communication		RS485 , Baykon BDLC protocol
Excitation, recommended	V (DC)	12
Excitation voltage range	V (DC)	10 - 16
Current consumption (at 12 V)	mA	23
Compensated temperature range	$^{\circ}C$	- 10 ... + 40
Operating temperature range	$^{\circ}C$	- 40 ... + 70
Material		Stainless steel
Protection class		IP68
Cable		Lenght: 5 m, \varnothing 5 mm, stainless steel braided sleeving

Dimensions (mm)

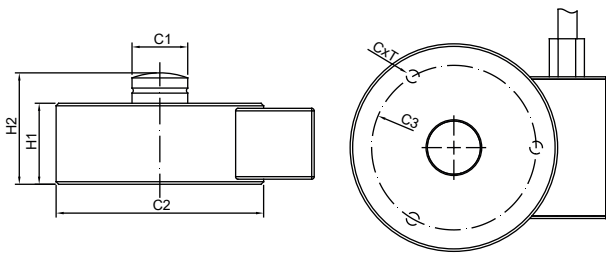

Capacity	C1	C2	C3	H1	H2	T
5-10 t	22	82	65	32	44	M6
15-20 t	28	100	80	35	48.5	M8

Color Codes

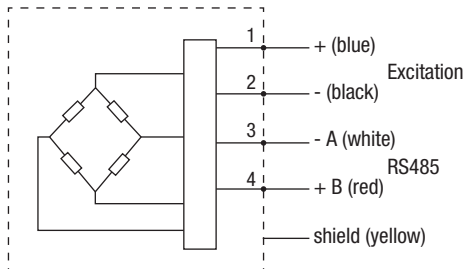

W Modules

