

Data Sheet for Precision adjustment Knobs

Precision adjustment knob with digit role and locking mechanism

Series MCD



Adjustment knob MCD in Ø30,5 mm housing with 3 digit display (10 rev.) and locking mechanism

- Knob with 3 digit display
- With locking mechanism
- For 3..6,35 mm shafts
- MCDK - version without decorative ring around the lens

The MCD series allows a very precise manual handling with 10 revolutions. The lock prevents unintentional adjustments.

Data adjustment knob

Number of full revolutions	10
Counter range of the adjustment knob	3 digit counter role (000..999)
Brake available	yes
For shaft diameter	3 mm / 3,175 mm / 4 mm / 6 mm / 6,35 mm
Shaft length (of sensor) over panel	max. 18 mm, min. 11 mm
Housing dimensions	30,5 mm
Housing depth	31,5 mm
Knob diameter	23 mm
Operating temperature range	-30..+60°C
Storage temperature range	-30..+60°C
Protection grade (IEC 60529)	IP42
Colour adjustment knob	Black - MCD with decorative ring, MCDK without
Material knob/housing	Plastic and metal
Mass	ca. 30 g
Mounting parts included in delivery	Fixing spacer, fixing ring, washer, hexagon socket wrench

Order code

Description	Selection: standard=black/bold, possible options=grey/cursive				
Series:	MCD				
Decorative ring: With decorative ring <i>Option without decorative ring</i>		- K			
For shaft diameter: Ø 6,00 Ø 6,35 <i>Option Ø 3</i> <i>Option Ø 3,175</i> <i>Option Ø 4</i>			6 MM 1/4 " 3 MM 3,17 MM 4 MM		

Data Sheet for Precision adjustment Knobs

Precision adjustment knob with digit role and locking mechanism

Series MCD

Drawing

MCD / MCDK

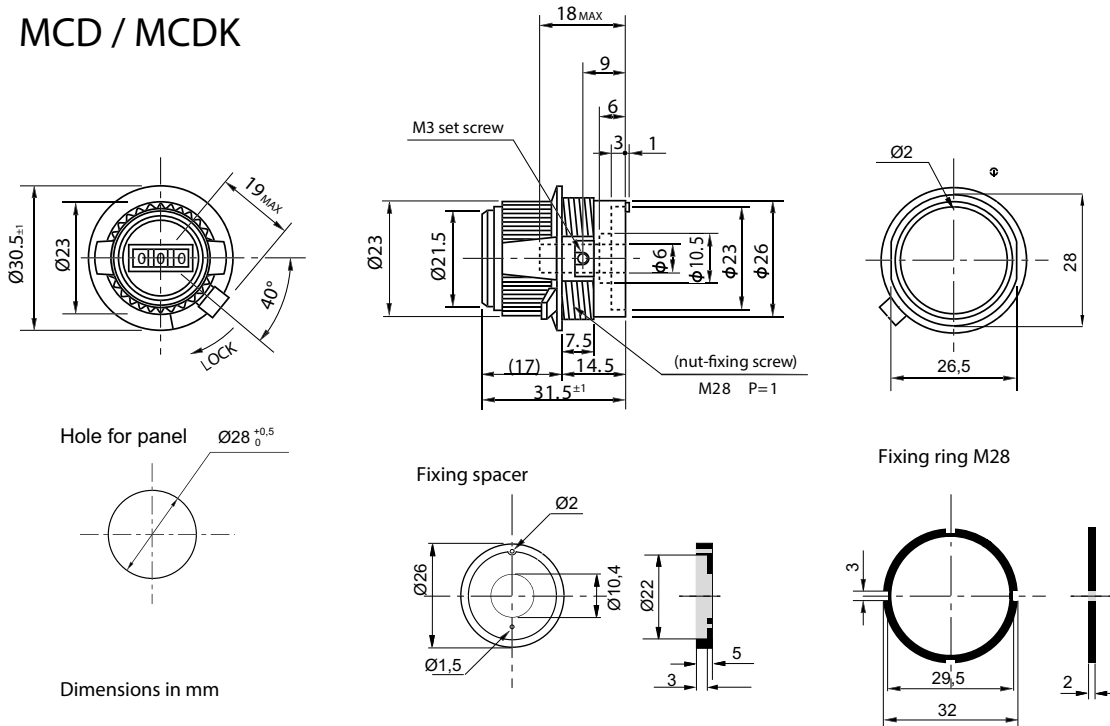

Dimensions in mm

Included in delivery: fixing spacer, washer, fixing ring and hexagon wrench

Note: For mounting fixing ring use wrench A30 according to DIN1810 or order MCM #106999 (wrench not included in delivery)

Ringnut Tool MCM not included in delivery

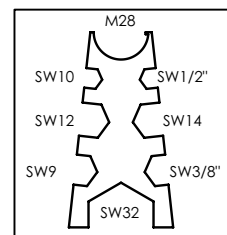

Mounting method example

